

RE-540LN (5 POLE). NOISE ATTENUATED

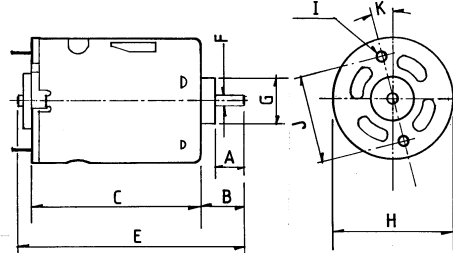

Part No. 457RE-540LN (WITH BRACKET)
 Part No. 719RE-540LN (WITHOUT BRACKET)
 Part No. 726 MOTOR BRACKET (90° ONLY)



Weight 212g (approx)

DIMENSIONS	A	B	C	E	F	G	H	I	J
Millimeter	5.5	9.75	57.1	69.2	3.175	14.0	37	M3	25.0

MODEL	VOLTAGE		NO LOAD		AT MAXIMUM EFFICIENCY					STALL TORQUE		
	OPERATING RANGE	NOMINAL	SPEED	CURRENT	SPEED	CURRENT	TORQUE		OUTPUT	EFF	TORQUE	
			R.P.M.	A	R.P.M.	A	oz-in	g-cm	W	%	oz-in	g-cm
RE-540LN	4.5 - 15	12v Constant	6000	0.26	5258	1.42	3.1	223	12.8	71	25.3	1825

Stall Current RE-540LN at 6v = 10.0 A