

RE-360 (3 POLE) & RE-360/1

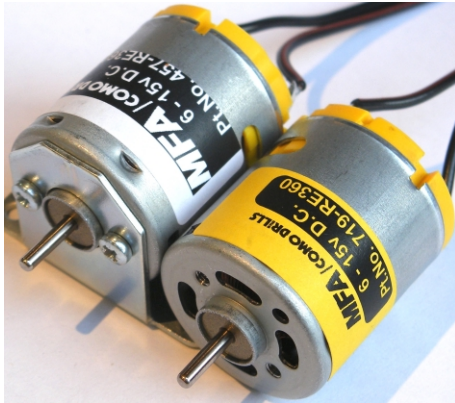

Part No. 457RE-360 (WITH BRACKET)
 Part No. 719RE-360 (WITHOUT BRACKET)
 Part No. 457RE-360/1 (WITH BRACKET)
 Part No. 719RE-360/1 (WITHOUT BRACKET)
 Part No. 725 MOTOR BRACKET (90° ONLY)

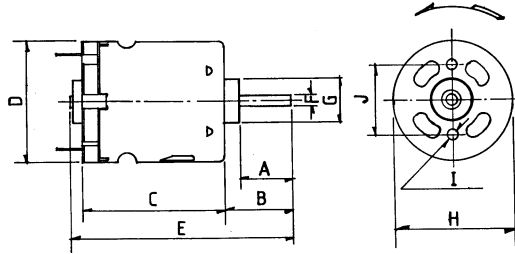

Weight 51g (approx)

DIMENSIONS	A	B	C	D	E	F	G	H	I	J
Millimeter	8.2	11.5	32.5	27.63	47.0	2.305	10.0	27.5	M2.6	16.0
Decimal Inches	0.323	0.453	1.28	1.088	1.85	0.091	0.394	1.083		0.63

MODEL	VOLTAGE		NO LOAD		AT MAXIMUM EFFICIENCY						STALL TORQUE	
	OPERATING RANGE	NOMINAL	SPEED	CURRENT	SPEED	CURRENT	TORQUE		OUTPUT	EFF	STALL TORQUE	
			R.P.M.	A	R.P.M.	A	oz-in	g-cm	W	%	oz-in	g-cm
RE-360	6 - 15	12v Constant	10420	0.143	8768	0.758		64.2	58	63.5		405.0
RE-360/1	3 - 6	6v Constant	10450	0.31	8706	1.55		63.4	56.6	60.9		379.8

Stall Current RE-360 at 12v = 4.02A. RE-360/1 at 6v = 7.73A